

Plat of Survey

of

Lot 3 in Block 2 of Elmhurst,

a subdivision located in the Northeast 1/4 of the Northwest 1/4 of Section 17,
Town 2 North, Range 16 East, City of Delavan, Walworth County, Wisconsin.

Surveyed for: **Sheila Lundin**
1105 Barnes Street
Delavan, Wisconsin. 53115



Bearings referenced to the North line of Barnes Street,
recorded as N56°E on the plat of Elmhurst.

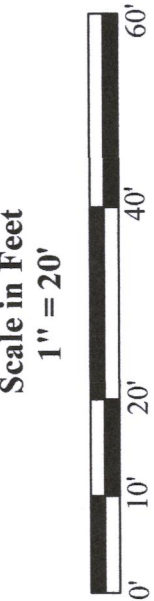

45 South Wisconsin Street | P.O. Box 322
Elkhorn, Wisconsin. 53121
Telephone: (262) 723-3434
Facsimile: (262) 723-8044
Email: doug@olsonsurveying.com
Website: www.olsonsurveying.com

OLSON
LAND SURVEYING, LLC
Rural | Residential | Commercial

Legend of Symbols & Abbreviations
N North
S South
W West
E East
B Bearings
I In
U Utility Pole
F Pedestal
M Minutes
S Seconds
D Distances
Inches
Feet

Found Iron Pipe
Found Iron Rod
Recorded Information
Utility Pole
Pedestal
Asphalt Surface
Concrete Surface
Brick Pavers

Sheet 1 of 1 Sheets
Drawing Name
Job Reference Number
2021.032

2021.032



- Notes:**
- 1) This Plat of Survey is not certified unless signed and sealed in red ink.
 - 2) This survey is subject to Wisconsin lien laws. This Plat of Survey is the notice of intent to file lien. Lien waiver required.
 - 3) The Survey Date shown on this Plat of Survey is the completion date of the field work.

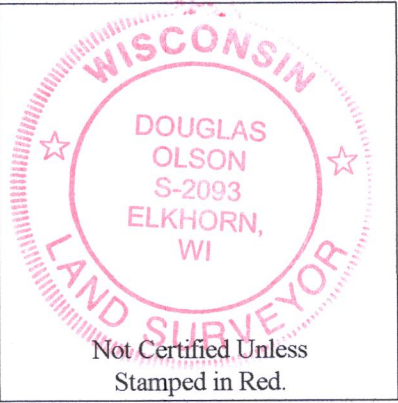
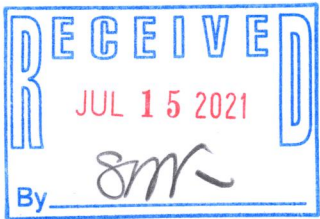

Copyright ©2021 by Olson Land Surveying, LLC.

All rights reserved. No part of this survey plat may be reproduced or transmitted in any form by any means - graphic, electronic, or mechanical, including photocopying, tracing, or information storage and retrieval systems - without permission in writing from Douglas G. Olson, Olson Land Surveying, LLC.

I hereby certify that I have surveyed the above described property in compliance with Chapter A-E 7 of the Wisconsin Administrative Code and that the map hereon is correct to the best of my professional knowledge and belief and shows the size and location of the property, its exterior boundaries, the location and dimensions of all visible structures thereon, boundary fences, apparent easements and roadways and visible encroachments, if any.
This survey is made for the exclusive use of the present owners of the property, and also those who purchase, mortgage or guarantee title thereto, within one year from the date hereof.

Douglas G. Olson
Wisconsin Professional Land Surveyor - 2093